

FIVE-YEAR PROJECTION OF BUILDING NEEDS
(An Annual Study)

May 1968

TOPEKA PUBLIC SCHOOLS
Dr. Merle Bolton, Superintendent

Evaluation Committee

Merle Bolton
Paul Boatwright
Ted Clark
Larry Gaston

Quentin Groves
Tom Kerr
Robert McKenzie
Giles Theilmann
Raymond Tilzey

TABLE OF CONTENTS

	PAGE
I. Priority List of Building and Site Needs Based Upon Funds Available	1-2
II. Background Information Pertaining to Priority Building and Site Needs	3-11
III. Recommendations for Consideration by the Topeka Board of Education	12
IV. Composite List of Building and Site Needs Identified and Updated -- 1968	13-15
REQUIREMENTS--REVENUES	
V. Projection of Special Building Fund	16
VI. Other Possible Sources of Revenue	17
VII. Projection on Availability of Special Building Funds . .	18
VIII. Alternate Plan for Providing Building Funds by the Issuance of Bonds	19-22
APPENDIX	

PRIORITY LIST OF BUILDING AND SITE NEEDS
BASED UPON FUNDS AVAILABLE
(MAY 1968)

<u>ITEM</u>	<u>ESTIMATED COSTS</u>
<u>Building and Site Needs From Funds Available in 1968</u>	
1. Topeka High -- Phase I of remodeling	\$ 24,000.00
2. Central Park Elementary	573,394.00
3. Marjorie L. French Jr. High -- to be completed in southwest Topeka for use by September 1970	1,200,000.00
4. Site Expansion	30,000.00
5. Potwin -- multi-purpose room	10,120.00
Total Estimated 1968 Expenditures	\$ 1,841,514.00
<u>Building and Site Needs From Funds Available in 1969</u>	
1. Topeka High -- Phase II of remodeling	\$ 141,000.00
2. Highland Park High -- construct 2 additional science classrooms	104,000.00*
3. Topeka West High -- expand physical education space	310,000.00*
4. Topeka West High -- industrial arts room	25,000.00
5. Topeka West High -- expand administrative space plus two classrooms	68,800.00
6. Site Expansion	30,000.00
7. Bishop Elementary -- complete 6-classroom addition	200,000.00
8. East Topeka Jr. High -- feasibility study	20,000.00
9. Highland Park Jr. High -- feasibility study	20,000.00
10. Central Park Elementary -- estimated costs for completion	30,000.00
Estimated 1969 Expenditures	\$ 948,800.00
<u>Building and Site Needs From Funds Available in 1970</u>	
1. Topeka High -- Phase III of remodeling	\$ 150,000.00
2. East Topeka Jr. High -- needs to be determined	
3. Highland Park Jr. High -- needs to be determined	
4. Highland Park High -- expand gymnasium and physical education facilities	575,000.00*
5. Acquire elementary school site in the vicinity of 37th and California	15,000.00
6. Curtis Jr. High -- remodel certain facilities for hot lunch program	25,000.00
7. Site Expansion	30,000.00
8. Grant Elementary -- multi-purpose room	15,000.00
9. Highland Park High -- parking lot	30,000.00
Estimated 1970 Expenditures	\$ 840,000.00**
<u>Building and Site Needs From Funds Available in 1971</u>	
1. Topeka High -- Phase IV of remodeling	\$ 150,000.00
2. East Topeka Jr. High -- needs to be determined	
3. Highland Park Jr. High -- needs to be determined	
4. Highland Park High -- relocate cafeteria and remodel classrooms	400,000.00*
5. Topeka West High -- construct fourth little school	250,000.00*
6. Randolph Elementary -- multi-purpose room and tornado shelter	55,000.00
7. Site Expansion	30,000.00
Estimated 1971 Expenditures	\$ 885,000.00**

*Adjusted for increase in building cost.

**Figures do not include expenditure for Highland Park Jr. High and East Topeka Jr. High.

<u>ITEM</u>	<u>ESTIMATED COSTS</u>
<u>Building and Site Needs From Funds Available in 1972</u>	
1. Topeka High -- Phase V of remodeling	\$ 150,000.00
2. Highland Park Jr. High -- needs to be determined	
3. East Topeka Jr. High -- needs to be determined	
4. Topeka West High -- auditorium	375,000.00
5. Site Expansion	<u>30,000.00</u>
Estimated 1972 Expenditures	\$ 555,000.00**

SUMMARY OF COSTS OF BUILDING NEEDS

Estimated 1968 Expenditures	\$ 1,841,514.00
Estimated 1969 Expenditures	948,800.00
Estimated 1970 Expenditures	240,000.00
Estimated 1971 Expenditures	885,000.00
Estimated 1972 Expenditures	<u>555,000.00</u>
Estimated Requirement for 1968-1972	\$ 5,070,314.00**
*Estimated Funds Available for 1968-1972	<u>4,905,260.42</u>
Estimated Deficiency of Revenue (When needs for East Topeka Jr. High and Highland Park Jr. High have been determined, this deficiency of revenue will be much greater.)	\$ 165,053.58

"Estimated Funds Available for 1968-1972" shown above as \$4,905,260.42 is \$611,514.00 greater than the total estimated available funds reported as Item 6 on Page 16. This difference is described in Item 4 on Page 16.

*This figure assumes the 5-mill levy will be extended.
**Figures do not include expenditure for Highland Park Jr. High and East Topeka Jr. High.

BACKGROUND INFORMATION
PERTAINING TO PRIORITY BUILDING AND SITE NEEDS
(MAY 1968)

The following information represents the concern of the Superintendent and staff pertaining to important building and site needs in the Topeka Public Schools, 1968-1972. Because of the known limitation on building and site revenues, a priority list of important building and site needs is set forth on Pages 1 and 2. It should be kept in mind that the Topeka Public Schools have been making capital improvements on a pay-as-you-go plan and the improvements with the highest priority are the only ones included in this section. Other urgent building and site improvements are listed on Pages 13-15. Appropriate background information on each priority is provided in the following paragraphs.

1968 Building and Site Needs

1. Topeka High -- Phase I (\$28,000)

The Topeka High School building is 37 years old. Since its construction in 1931, there have been many curricular and instructional innovations which make it desirable that some remodeling be done within the building. The estimated emergency capacity for Topeka High School is approximately 2,400. Phase I of remodeling is that part of the total remodeling program at Topeka High School which can be accomplished during the summer without interrupting the beginning of school in the fall. The work in Phase I will be in the physical education area. The amount of funds to be spent in Phase I was lowered considerably because of the lack of available materials. The other remodeling formerly specified in Phase I will be done in Phase II.

2. Central Park Elementary -- Being reconstructed using insurance and federal relief funds. (School was destroyed June 8, 1966 by tornado.) (\$573,394)

3. Marjorie L. French Jr. High -- To be completed in southwest Topeka for use by September 1970 (\$1,200,000)

The following is a report pertaining to the estimated enrollment for the proposed new junior high school prepared by Mr. R. F. Tilzey on April 15, 1968:

"The tentative attendance area for the proposed junior high school at 33d and Fairlawn Road is described as follows: beginning at the intersection of West 21st Street and Fairlawn Road and running south along Fairlawn Road to a point where said road crosses the Shunganunga Creek; then easterly along the Shunganunga Creek to Gage Boulevard to the south right-of-way of Interstate Highway 470; then southeasterly to a point where said right-of-way meets Atwood Avenue extended north from 37th Street; then south along Atwood Avenue extended south to West 37th Street; then west along 37th Street, and continuing west and north along the boundary of the corporate city to the point where said boundary meets West 21st Street; then east along West 21st Street to place of beginning.

1968 Building and Site Needs (Cont'd)

"The following tables show the estimated enrollments in the proposed junior high school, also the estimated enrollments of the junior high schools that would be affected by the opening of the new school. These are Landon, Capper, and Jardine.

"These estimates were produced by advancing the students enrolled on January 19, 1968 in the contributing elementary schools, in Grades 1 through 6, to junior high levels (7, 8, and 9). The years covered are 1969-70 through 1973-74. These estimates do not include probable growth in the Landon, Jardine, and new school attendance areas. The attendance area assigned to Capper is not likely to show any appreciable growth. See footnotes for statements regarding probable growth.

"PROPOSED NEW SCHOOL* There is within this school's tentative attendance area a rather large tract of unplatted and undeveloped land. It seems likely that much of this undeveloped area will be built up into residential additions some time in the future.

Estimated Enrollment	1969-70	358
	1970-71	354
	1971-72	360
	1972-73	373
	1973-74	378

"In view of the estimated enrollment and probable growth, I would suggest that a school be constructed to initially house 450 junior high school students with ultimate capacity for 900 students. In the early years of this school's existence, a portion of the space possibly not needed for junior high purposes might be used by elementary students to temporarily relieve probable overcrowding at McClure School.

"LANDON JUNIOR HIGH**

Estimated Enrollment	1969-70	400
	1970-71	383
	1971-72	371
	1972-73	349
	1973-74	356

Effective Instructional Capacity 375

"The estimated enrollment will maintain Landon Junior High almost to capacity of 375. There is some undeveloped territory within this school's attendance area, reduced by the inclusion of the new school. This undeveloped territory seems likely to build up very slowly. This would indicate that the present Landon School facility will serve the territory for several years in the future.

1968 Building and Site Needs (Cont'd)

"CAPPER JUNIOR HIGH

Estimated Enrollment	1969-70	511
	1970-71	509
	1971-72	499
	1972-73	490
	1973-74	492
Effective Instructional Capacity		600

"The current attendance area of Capper Junior High will not be changed by the establishment of the proposed junior high at 33d and Fairlawn Road. However, the estimates show a decline from current enrollments. This decline will probably occur because a portion of the Capper attendance area was assigned to Landon beginning with the school year 1966-67, with the provision that students who were already enrolled in Capper would be allowed to complete their junior high schooling in Capper. By 1969 this provision would no longer be applicable.

"These estimates are somewhat below Capper's stated capacity and there is very little space for additional housing in this school attendance area. However, it should be noted that a portion of this school's facility should be refurbished.

"JARDINE JUNIOR HIGH***

Estimated Enrollment	1969-70	708
	1970-71	722
	1971-72	732
	1972-73	747
	1973-74	754
Effective Instructional Capacity		750

"The estimated enrollments indicate that this school will be operating below its stated capacity for a short while. However, there is some territory in this school's attendance area that is not developed but most of this undeveloped territory is platted and is in the process of building up. It seems quite likely that there will be, within the next five years, enough new places of residence to provide enough students to fill the school to capacity.

* * * * *

"As an additional statement, the total of the foregoing estimates for 1970-71 will exceed the total of the stated instructional capacities of Landon, Capper, and Jardine by approximately 252 students.

1968 Building and Site Needs (Cont'd)

"*Within the tentative attendance area for the proposed Marjorie French Junior High School are several plotted and developing areas.

WESTPORT SUBDIVISION - 2 developers with:

- 15 completed houses
- 5 under construction
- 275 building sites

The developers hope to complete these areas within 3 to 5 years time.

THE GATEHOUSE APARTMENT COMPLEX with:

- 312 living units - approximately 200 of these are or will be 2-bedroom apartments.

This development is to be completed early in the summer of 1968.

ARROWHEAD SUBDIVISIONS 3 and 5 - SKYLINE PARK SUBDIVISION AND COUNTY FAIR ESTATES:

South of I-470 and on both sides of Gage Boulevard. There are nearly 300 potential building sites in these areas. However, the construction of homes in these areas has been quite slow in the last few years but still remains a potential for many homes.

OLD FARM SUBDIVISION - In the last year there have been several homes completed in this area. There are 26 sites available for homes. This development will probably be completed in 1968.

"In light of the foregoing data, it seems likely that within the next 5 to 8 years there might well be an additional 200 junior high school students living in this general area.

"**Within the attendance area of Landon Junior High School, reduced by the tentative area of the Marjorie French School, there is considerable amount of undeveloped land. However, to date there is little information readily available regarding housing construction within this area. One exception is the Village Development which is approaching completion.

"***Within the attendance area of Jardine Junior High School, reduced by the tentative area of the Marjorie French School, the developers have plans for approximately 260 single-family homes and 200 living units in an apartment complex. The builders hope to have this construction completed within 5 years."

4. Site Expansion (\$30,000)

These funds will be used to enlarge existing sites. Sites which have been given priority are Grant, Lundgren, and Highland Park Jr. High School.

1969 Building and Site Needs

1. Topeka High -- Phase II (\$141,000)

See Item 1 under 1968 Building and Site Needs.

2. Highland Park High -- Construct two additional science classrooms (\$104,000)

Highland Park High School's main building is 18 years old with additions being completed in 1955 and 1965. The capacity of the building is approximately 1,300. The enrollment at Highland Park High School is estimated at 1,405 for September 1968. By September 1971, enrollment is expected to be 1,382. (This figure takes into consideration the boundary changes but not additional building complexes in the attendance center.) The estimated cost of this project includes equipment and architect's fees. (Refer to Ekdahl, Davis and Depew, Architects' report on Highland Park High School, Pages 32-34.)

3. Topeka West High -- Expand physical education space (\$310,000)

The gymnasium at Topeka West High School was originally designed so that it could be built in two phases--the first to serve a school of 900 pupils, and the second to bring it up to a level of 1,350. The second phase never has been built. Present gymnasium and locker room spaces are inadequate to serve the present school population. Many students are sharing lockers.

The present gymnasium has three teaching stations with a spectator seating capacity of 1,500. If the school is to be planned to serve 1,900 pupils, five teaching stations are required. One of these additional stations could serve also as a spectator area. (Refer to Ekdahl, Davis and Depew, Architects' report on Topeka West High School, Pages 35-37.)

4. Topeka West High -- Industrial arts room (\$25,000)

Topeka West High is seven years old. The design of the building has provided for utilization of newer curricular and instructional innovations. The capacity of Topeka West is approximately 1,300 pupils. The projected enrollment in 1969 is 1,492. This additional space is needed to bring the building to its original capacity. In September 1968 the projected number of portable classrooms to be used at Topeka West High is nine. These projections include the new boundary changes but do not include additional home construction. (Refer to Ekdahl, Davis and Depew, Architects' report on Topeka West High School, Pages 35-37.)

5. Topeka West High -- Expand administrative space plus two classrooms (\$68,800)

See Item 4.

6. Site Expansion (\$30,000)

See Item 4 under 1968 Building and Site Needs.

1969 Building and Site Needs (Cont'd)

7. Bishop Elementary -- Complete 6-classroom addition (\$200,000)

Bishop is three years old. Every room and five portables are presently being utilized. The capacity of the building is 330. The estimated enrollment at Bishop for September 1968 is 467. The adjacent elementary schools of Avondale West, Avondale Southwest, and McEachron are at near-capacity. McEachron School will have only one vacant classroom. These projections do not include additional home construction.

8. East Topeka Jr. High -- Feasibility study (\$20,000)

The East Topeka Jr. High School was constructed in 1936 and ranks seventh as to age of the major structure among the eleven junior high schools in the city. The building is a sound structure but is reaching the point where the "common areas" are needing to be enlarged along with major renovations. Some of the building's classrooms also need to be remodeled.

In order to determine the feasibility of remodeling and site enlargement or relocation of the school, it is recommended that the Board conduct a comprehensive study to make sound long-range plans for this school. The relationship between East Topeka Jr. High and Highland Park Jr. High as to location further emphasizes the need for a feasibility study.

9. Highland Park Jr. High -- Feasibility study (\$20,000)

The Highland Park Jr. High School was originally built in 1935 to be used as a high school building. It was later converted to junior high school use when the new high school was built.

It is for this reason--plus the very poor site conditions--that we feel a complete feasibility study, rather than just a remodeling plan, should be made. It should be noted, however, that a sizable addition to this building was constructed in 1959.

10. Central Park Elementary -- Estimated costs for completion (\$30,000)

1970 Building and Site Needs

1. Topeka High -- Phase III (\$150,000)

See Item 3 under 1968 Building and Site Needs. Since complete remodeling cannot be accomplished in the summertime, a portion of this money could be used to rent or purchase portable classroom space for use while remodeling classrooms during the school year.

2. East Topeka Jr. High

This item will depend upon the study made in Item 8 (1969).

3. Highland Park Jr. High

This item will depend upon the study made in Item 9 (1969).

1970 Building and Site Needs (Cont'd)

4. Highland Park High -- Expand gymnasium and physical education facilities (\$575,000)

The 18-year-old building contains a gymnasium, cafeteria, and school kitchen area, none of which was designed for a total building enrollment of 1,300. The gymnasium has the present capacity of approximately 1,100 spectators. At the present time, four physical education classes are crowded into the two-station area, and four classes dress in locker rooms designed for two classes. Showering and dressing are extremely difficult and inadequate for the present enrollment. Five teaching stations are necessary for the anticipated enrollment. Locker and shower space needs to be doubled for the boys and more than doubled for the girls to adequately handle the anticipated enrollment. Seniors are not permitted to enroll in physical education because of limited space and facilities. (Refer to Ekdahl, Davis and Depew, Architects' report on Highland Park High School, Pages 32-34.)

5. Acquire elementary school site in the vicinity of 37th and California (\$15,000)

Since Highland Park South Elementary School and Linn Elementary School are operating at near-capacity, it is desirable for the Topeka Public Schools to have a school site in the vicinity of 37th and California to have the capability of meeting future elementary school needs in southeast Topeka.

6. Curtis Jr. High -- Remodel certain facilities for hot lunch program (\$25,000)

The highest priority schools at the junior high level for providing hot lunch facilities are Curtis Jr. High School and East Topeka Jr. High School. It is estimated this amount would provide for serving and dining table area. It is thought at this time the food will be transported to the school.

7. Site Expansion (\$30,000)

See Item 4 under 1968 Building and Site Needs.

8. Grant Elementary -- Multi-purpose room (\$15,000)

At the present time, Grant has a small area which is a remodeled manual training room. It serves as a playroom and lunchroom. The plan calls for remodeling the auditorium into a large multi-purpose room much like Potwin Elementary School.

9. Highland Park High -- Parking lot (\$30,000)

This improvement has been delayed to allow the city to complete work on California Avenue. The improvement of the parking lot will consist of repaving, enlarging, and perhaps a second parking lot.

1971 Building and Site Needs

1. Topeka High -- Phase IV (\$150,000)

See Item 1 (1970).

1971 Building and Site Needs (Cont'd)

2. East Topcka Jr. High

See Item 2 (1970).

3. Highland Park Jr. High

See Item 3 (1970).

4. Highland Park High -- Relocate cafeteria and remodel classrooms (\$400,000)

See Item 2 (1969) and Item 4 (1970) for enrollment and capacity figures. It is recommended that the cafeteria and kitchen be relocated in the old gym and the present cafeteria be remodeled into classroom space and counseling office space. (Refer to Ekdahl, Davis and Depew, Architects' report on Highland Park High School, Pages 32-34.)

5. Topeka West High -- Construct fourth little school (\$250,000)

The capacity of Topeka West is approximately 1,300 pupils. The estimated enrollment for Topeka West in September of 1971 is 1,378. The new boundary changes do not take into consideration the growth which is anticipated in the Topeka West attendance area. In September 1968, nine portable classrooms will be used at Topeka West. These projections include the new boundary changes but do not include additional home construction. (Refer to Ekdahl, Davis and Depew, Architects' report on Topeka West High School, Pages 35-37.)

6. Randolph Elementary -- Multi-purpose room and tornado shelter (\$55,000)

Randolph Elementary School has no modern multi-purpose room. There was an area constructed less than 60 feet in length and about the size of two normal classrooms, which has been used as a multi-purpose room, but which is far below the average size of the multi-purpose rooms constructed in other schools.

7. Site Expansion (\$30,000)

See Item 4 (1968).

1972 Building and Site Needs

1. Topeka High -- Phase V (\$150,000)

See Item 1 (1970). The central physical plant facilities are scheduled to be remodeled in either the fifth or sixth phase and the funds for such a large remodeling phase have not been included in this report. At this time, the cost is not known nor the exact year in which this should be completed. These questions should be answered by the Master Plan, which will be released later.

2. Highland Park Jr. High

See Item 3 (1970).

1972 Building and Site Needs (Cont'd)

3. Topeka West High -- Auditorium (\$375,000)

See Items 3 and 4 under 1969 section and Item 5 under 1971 section. The present auditorium at Topeka West has a capacity of 620 pupils. With the anticipated enrollment, a larger auditorium for all school events is desirable. The present auditorium should be converted into large-group teaching areas through the use of portable partitioning. (Refer to Ekdahl, Davis and Depew, Architects' report on Topeka West High School, Pages 35-37.)

4. Site Expansion (\$30,000)

See Item 4 (1968).

RECOMMENDATIONS FOR CONSIDERATION
BY THE TOPEKA BOARD OF EDUCATION

RECOMMENDATION NO. 1

That the Topeka Board of Education adopt a tentative proposal to remodel the interior of Topeka High School and build necessary additions to Highland Park High and Topeka West High when necessary as outlined in the "Priority List of Building and Site Needs -- 1966." By adding to Highland Park High and Topeka West High plus remodeling Topeka High School, the district would be improving instructional areas for approximately 5,000 high school students in the district and not for a segment fortunate enough to attend a new building. This would increase the capacity of Highland Park High School by approximately 420 students and Topeka West High School by approximately 600 students. (In accordance with the suggested solution to the question of a fourth high school building or building additions to the present high schools stated in the 1966 five-year study.

RECOMMENDATION NO. 2

That the Topeka Board of Education utilize the funds derived from "Other Possible Sources of Revenue" (\$446,000 described on Page 17) to finance building priority needs.

RECOMMENDATION NO. 3

That the Topeka Board of Education consider the passage of a resolution, in 1969, under authority of Senate Bill No. 587, 1967 Session of the Kansas Legislature, to make a levy of 4 mills annually for a period of 5 years for a Special Building Fund, then in 1969 issue bonds under authority of this Senate Bill. Under this procedure, the Special Building Fund levy would be reduced from 5 mills to 4 mills. (See "Alternate Plan for Providing Building Funds by the Issuance of Bonds," Pages 19-22.)

RECOMMENDATION NO. 4

That the Topeka Board of Education consider holding an election for authority to issue general obligation bonds to finance needed facilities. Many of these needs are listed on Pages 13-15, as well as junior high school needs to be determined by the feasibility study, and other long-range building needs to be determined. This action may be necessary since Recommendations Nos. 2 and 3 cannot adequately finance the possible building needs outlined in this report.

COMPOSITE LIST OF BUILDING AND SITE NEEDS
IDENTIFIED AND UPDATED -- 1968

The letters in the blanks preceding the statements below indicate the status of each project considered:

S -- Under Study
W -- Work in Progress

I. NEW BUILDINGS

Elementary

- W 1. Central Park Elementary building replacement.

Junior High

- S 2. A new junior high school vicinity 33d & Fairlawn (Marjorie French Junior High).

Senior High

A commitment should be made for a period of ten years as to the remodeling of the three high schools for enrollments of 1,800 to 2,100.

Vocational

- W 3. Vocation building replaced. (Will open September, 1968)

II. BUILDING ADDITIONS OR REMODELING NEEDS

Elementary

- S 1. Bishop -- build a 6-classroom addition.
W 2. Six-classroom addition at Highland Park South.
S 3. Build Grant multi-purpose room or convert present auditorium into multi-purpose room.
W 4. Potwin -- build a multi-purpose room or convert present auditorium into multi-purpose room.
S 5. Randolph -- build a multi-purpose room and tornado shelter.
S 6. State Street -- 4-classroom addition needed.
S 7. Sumner -- build a multi-purpose room or convert present auditorium into multi-purpose room.
S 8. Hudson -- 4-classroom addition.
S 9. Parkdale old building replacement.

Junior High

- W 10. Expansion of Landon kitchen to provide storage area of approximately 350 square feet.
S 11. Replace Boswell Junior High old building.
S 12. East Topeka Junior High -- feasibility study.
S 13. Highland Park Junior High -- feasibility study.

II. BUILDING ADDITIONS OR REMODELING NEEDS (Cont'd)

Senior High

- S 14. Highland Park High -- remodel by phases. See attached plan (physical education facilities, cafeteria, classrooms, art, science).
- W 15. Highland Park High -- expand library.
- S 16. Topeka West High -- additions by phases. See attached plan (mechanical drawing, home economics, physical education, administrative area, classrooms, auditorium).
- W 17. Topeka West High -- expand library facilities.
- W 18. Topeka High -- Master Plan.
- W 19. Topeka High -- Phase I.
- S 20. Topeka High -- Phases II, III, IV, V.

III. SITE ACQUISITIONS NEEDED FOR NEW SCHOOLS

Elementary

- S 1. Elementary school site vicinity 37th and California.
- S 2. Elementary school site vicinity Westport Subdivision.

Junior High

Senior High

A commitment should be made for a period of ten years as to the remodeling of the three high schools for enrollments of 1,800 to 2,100.

IV. SITE EXPANSION FOR OLDER SCHOOLS

Elementary

- S 1. Site expansion of Grant.
- S 2. Site expansion of Lowman Hill.
- S 3. Site expansion of Lundgren.
- S 4. Site expansion of Potwin.
- S 5. Site expansion of Randolph.
- S 6. Site expansion of Sheldon.
- S 7. Site expansion of Sumner.

Junior High

- S 8. Site expansion of Boswell.
- S 9. Site expansion of East Topeka.
- S 10. Site expansion of Highland Park Junior High.
- S 11. Site expansion of Holliday.

Senior High

- S 12. Site expansion of Topeka High.

V. OTHER SIGNIFICANT IMPROVEMENTS NEEDED

Elementary

- S 1. All elementary schools provided with central library areas.
- S 2. Gage Elementary School drive and parking.

Junior High

- S 3. Boswell -- increase physical education locker room facilities.
- S 4. Capper -- increase physical education facilities.
- S 5. Crane -- increase industrial arts facilities.
- S 6. Crane -- remodel physical education facilities.
- S 7. Crane -- remodel auditorium.
- S 8. Curtis -- remodel physical education facilities.
- S 9. Curtis -- remodel school for a hot lunch program.
- S 10. Holliday -- remodel physical education facilities.
- S 11. Holliday -- remodel home economics facilities.
- S 12. Roosevelt -- remodel physical education facilities.
- S 13. Capper -- expand kitchen
- S 14. Highland Park Junior High -- expand kitchen and cafeteria (serves elementary and junior high).

Senior High

- S 15. Topeka West -- parking lot asphalt completion.
- S 16. Highland Park High -- parking lot.

VI. ADMINISTRATION, OPERATION, AND TORNADO SHELTER AREAS

Administration

- S 1. Administration Building -- relocate or build a new Administration Building facility.

Operation

- S 2. School Shop -- replace and relocate school shop, which was built in 1887.
- S 3. Food Service Center -- build a Food Service Center to supply hot lunches to various schools.

Tornado Shelter Areas

- S 4. Needs to be determined.

UNIFIED SCHOOL DISTRICT NO. 901
Office of Business Affairs
415 West Eighth Street
Topeka, Kansas

PROJECTION OF SPECIAL BUILDING FUND
February 29, 1968

1.	Treasurer's Cash Balance, Feb. 29, 1968		\$1,648,680.80
2.	Deduct, Incompleted Orders:		
	a. 1968 Contracts	\$ 3,465.73	
	b. Prior Year	<u>254,358.95</u>	
	Total Incompleted Orders		<u>257,824.68</u>
3.	Unencumbered Cash Balance, Feb. 29, 1968		\$1,390,856.12
4.	Deduct Estimated Cost of Work to be Contracted in 1968		
	a. Central Park School	\$ 573,394.00	
	b. Potwin Multi-Purpose Room	10,120.00	
	c. Topeka High School Remodeling	<u>28,000.00</u>	
		\$ 611,514.00	\$ 611,514.00
5.	Add:		
	a. Estimated Tax Receipts for 1968		
	1967 Tax Levied	\$ 706,734.00	
	Less: 1967 Tax Collected through Feb. 29, 1968	-482,193.85	
	Less: Allowance for Delinquent Tax	<u>- 14,000.00</u>	
		\$ 210,540.15	
	b. Remaining 50% of Insurance Claim on Central Park School	\$ 175,668.15	
	c. Federal Assistance on Central Park Building Replacement (\$145,440.00 less \$14,544.00)	\$ 130,896.00	
	d. Estimated Tax Receipts for Future Years		
	1969 Est. Val. \$153,000,000. @ 4.85 Mills	\$ 742,050.00	
	*1970 " " 154,000,000. " " "	746,900.00	
	*1971 " " 155,000,000. " " "	751,750.00	
	*1972 " " 156,000,000. " " "	<u>756,600.00</u>	
		\$2,997,300.00	
	Total Estimated Receipts		<u>\$ 3,514,404.30</u>
6.	Total Estimated Funds That Will Become Available Between Feb. 29, 1968 and Dec. 31, 1972		<u>\$ 4,293,746.42</u>

*This assumes 5-Mill Levy will be extended.

OTHER POSSIBLE SOURCES OF REVENUE

In addition to the revenue from the Special Building Fund levy, other possible sources of revenue include the following:

	<u>Est. Revenue</u>
1. Disposal of surplus land.	
A. Topeka Trade School Site	
B. Jardine Junior High ----- approximately 1.5 acres	
Total	\$130,000.
2. Proceeds from bonds authorized in 1960	23,000.
3. Disposal property which should be considered as a source of revenue or put to school use -- 23rd and Tyler site.	
The 23rd and Tyler site contains approximately 13 acres, and the following alternatives for a more useful implementation of this site are as follow:	
A. Retain for a sports center location.	
B. Retain for a possible relocation of Crane Junior High.	
C. Sell and use proceeds for school building and site needs.	
4. That portion of the 1960 bond election fund for a school designated at 8th and Morningside (site already purchased).	
The school that was designated in the 1960 bond election fund has not yet been built nor does there appear an early need for this elementary school.	
The amount in this unexpended portion of this bond fund is	<u>293,000.</u>
Total of possible other sources of revenue excluding the estimate of revenue from 23rd and Tyler site	\$446,000.

UNIFIED SCHOOL DISTRICT NO. 501
 Office of Business Affairs
 415 West Eighth Street
 Topeka, Kansas

Projection on Availability of Special Building Funds

April 3, 1968

1. Estimated Unencumbered Balance 12-31-68		\$2,308,340.42
2. Estimate of Tax Collections as of June 1:		
a. 1969 - 68% of \$742,050.00	\$504,594.00	
b. 1970 - 32% of \$742,050.00	237,456.00	
c. 1970 - 68% of \$746,900.00	<u>507,872.00</u>	
d. 1970 - Total	\$745,348.00	
e. 1971 - 32% of \$746,900.00	\$239,008.00	
f. 1971 - 68% of \$751,750.00	<u>511,190.00</u>	
g. 1971 - Total	\$750,198.00	
h. 1972 - 32% of \$751,750.00	\$240,560.00	
i. 1972 - 68% of \$756,600.00	<u>514,488.00</u>	
j. 1972 - Total	\$755,048.00	
k. Total Estimated Tax Collections to June 1, 1972		<u>2,755,188.00</u>
3. Total Unencumbered Balance 12-31-68 and Estimated Tax Collections to 6-1-72		\$4,063,528.42
4. Estimate of Tax Collections 6-1-72 to 12-31-72 32% of \$756,600.00		<u>242,112.00</u>
		\$4,305,640.42*

*This figure assumes the 5-mill levy will be extended.

Alternate Plan for Providing Building
Funds by the Issuance of Bonds

Under authority of 1967 Supplement, K.S.A. 1048-g and by resolution adopted by our Board on July 3, 1967, our Board has authority to levy a 5 mill advalorem tax levy in 1968 for purposes of a special building fund. It is estimated this levy in 1968 will produce \$742,050.00. It is estimated \$504,594.00 or 68% of this amount would be received by June 1, 1969, and the remaining \$237,456.00 or 32% would be received by January 1, 1970. Rather than request legislation in 1969 to extend the authority to levy 5 mills under K.S.A. 1048-g our Board may elect to adopt a resolution to make a 4 mill levy under authority of Senate Bill No. 587, 1967 Session of Kansas Legislature. If the Board so elected the necessary resolution would need to be adopted early in 1969 and, providing there was not a sufficient petition filed in opposition to the action, the first such tax levy could be made in 1969. The period specified for the levy to be made cannot exceed five years. This would permit the levy to be made in 1969, 1970, 1971, 1972 and 1973. It is estimated taxes from these levies would be received on or before June 1 each year as shown in the following schedule:

<u>1970</u>		
\$153,000,000. @ 3.88 mills x 68%	<u>\$403,675.00</u>	\$403,675.00
<u>1971</u>		
\$153,000,000. @ 3.88 mills x 32%	\$189,964.00	
\$154,000,000. @ 3.88 mills x 68%	<u>406,313.00</u>	\$596,277.00
<u>1972</u>		
\$154,000,000. @ 3.88 mills x 32%	\$191,206.00	
\$155,000,000. @ 3.88 mills x 68%	<u>408,952.00</u>	\$600,158.00

1973

\$155,000,000. @ 3.88 mills x 32% \$192,448.00
\$156,000,000. @ 3.88 mills x 68% 411,590.00

\$ 604,038.00

1974

\$156,000,000. @ 3.88 mills x 32% \$193,689.00
\$157,000,000. @ 3.88 mills x 68% 414,228.00

\$ 607,917.00

1975

\$157,000,000. @ 3.88 mills x 32% \$194,931.00

\$ 194,931.00

Total for Five Year Period

\$3,006,996.00

Under the provisions of Senate Bill No. 587, bonds could be issued in 1969. If bonds were issued in 1969 the amount of the issue could not exceed \$2,600,000.00. The remainder of the "Total for Five Year Period - \$3,006,996.00" shown above or \$406,996.00 would be required to pay the interest on the bonds.

If bonds were sold in 1969 under authority of Senate Bill No. 587, then the scheduling of expenditures for building and site needs could be advanced as shown on the following schedule:

1968 Building and Site Needs

<u>Item</u>	<u>Estimated Cost</u>
1. Topeka High - Phase I of Remodeling	\$ 28,000.00
2. Central Park Elementary	573,394.00
3. Marjorie L. French Jr. High - to be completed in southwest Topeka for use by September, 1970.	1,200,000.00
4. Potwin Auditorium - Multi-purpose room	10,120.00

5. Site Expansion

\$ 30,000.00

Total Estimated 1968 Expenditures

1,841,544.00
~~1,829,544.00~~

1969 Building and Site Needs

<u>Item</u>	<u>Estimated Cost</u>
1. Topeka High - Phase II of Remodeling	\$241,000.00
2. Highland Park High - Construct two additional science rooms	104,000.00
3. Topeka West High - Expand physical education space, construct industrial arts room and expand administrative space plus two classrooms	403,800.00
4. Bishop - Add 6 classrooms	200,000.00
5. East Topeka Jr. High - Feasibility Study	20,000.00
6. Highland Park Jr. High - Feasibility Study	20,000.00
7. Central Park Elementary - Estimated Cost for completion	30,000.00
8. Site Expansion	<u>30,000.00</u>
Total Estimated 1969 Expenditures	\$948,800.00

1970 Building and Site Needs

1. Topeka High - Phase III of Remodeling	150,000.00
2. East Topeka Jr. High - Needs to be determined	
3. Highland Park Jr. High - Needs to be determined	
4. Highland Park High - Expand gymnasium and physical education facilities, improve parking lot, and relocate cafeteria and remodel classrooms	1,005,000.00
5. Acquire elementary school site in the vicinity of 37th and California	15,000.00
6. Curtis Junior High - Remodel certain facilities for hot lunch program	25,000.00
7. Grant School - Multi-purpose room	15,000.00
8. Topeka West High - Construct fourth little school and auditorium	625,000.00

9. Site Expansion	\$ 50,000.00
10. Randolph School - Multi-purpose room and shelter	<u>55,000.00</u>
Total Estimated 1970 Expenditures	\$1,980,000.00 *

1971 Building and Site Needs

<u>Item</u>	<u>Estimated Cost</u>
1. Topeka High - Phase IV of Remodeling	\$ <u>150,000.00</u>
	\$ 150,000.00

1972 Building and Site Needs

<u>Item</u>	<u>Estimated Cost</u>
1. Topeka High - Phase V of Remodeling	\$ <u>150,000.00</u>
	\$ 150,000.00

* It is to be noted the "Total Estimated 1970 Expenditures" does not include any amounts for East Topeka Junior High and Highland Park Junior High.

SUMMARY

Estimated 1968 Expenditures	\$1,841,514.00
Estimated 1969 Expenditures	948,800.00
Estimated 1970 Expenditures	1,980,000.00
Estimated 1971 Expenditures	150,000.00
Estimated 1972 Expenditures	<u>150,000.00</u>
Total Expenditures for 5-year projection	\$5,070,314.00
Total Funds Available for 5-year projection	<u>5,250,020.00</u>
Estimated Surplus of Funds	\$ 179,696.00

APPENDIX

	PAGE
POPULATION--ENROLLMENT	
Parochial, County, and City School Enrollment Trends	24
Elementary and Secondary Enrollment Trends	25
City Population and Total Enrollment Trends	26
Births in Topeka School District	27
Estimated Enrollments by Grade Levels and Five-Year Birth Record	28
BUILDINGS	
Building Projects Completed Since 1961	29
Ages of School Buildings Now Being Utilized	30
Age of Original Structure	31
Ekdahl, Davis & Depew Architects' Report on Highland Park High School	32-34
Ekdahl, Davis & Depew Architects' Report on Topeka West High School	35-37
SITES	
Areas of Tracts of Land Owned by the Topeka Board of Education	
Elementary	38
Junior High	39
Senior High	40
Miscellaneous	41
Totals	42

SEPTEMBER ENROLLMENTS (Gr. K-12)

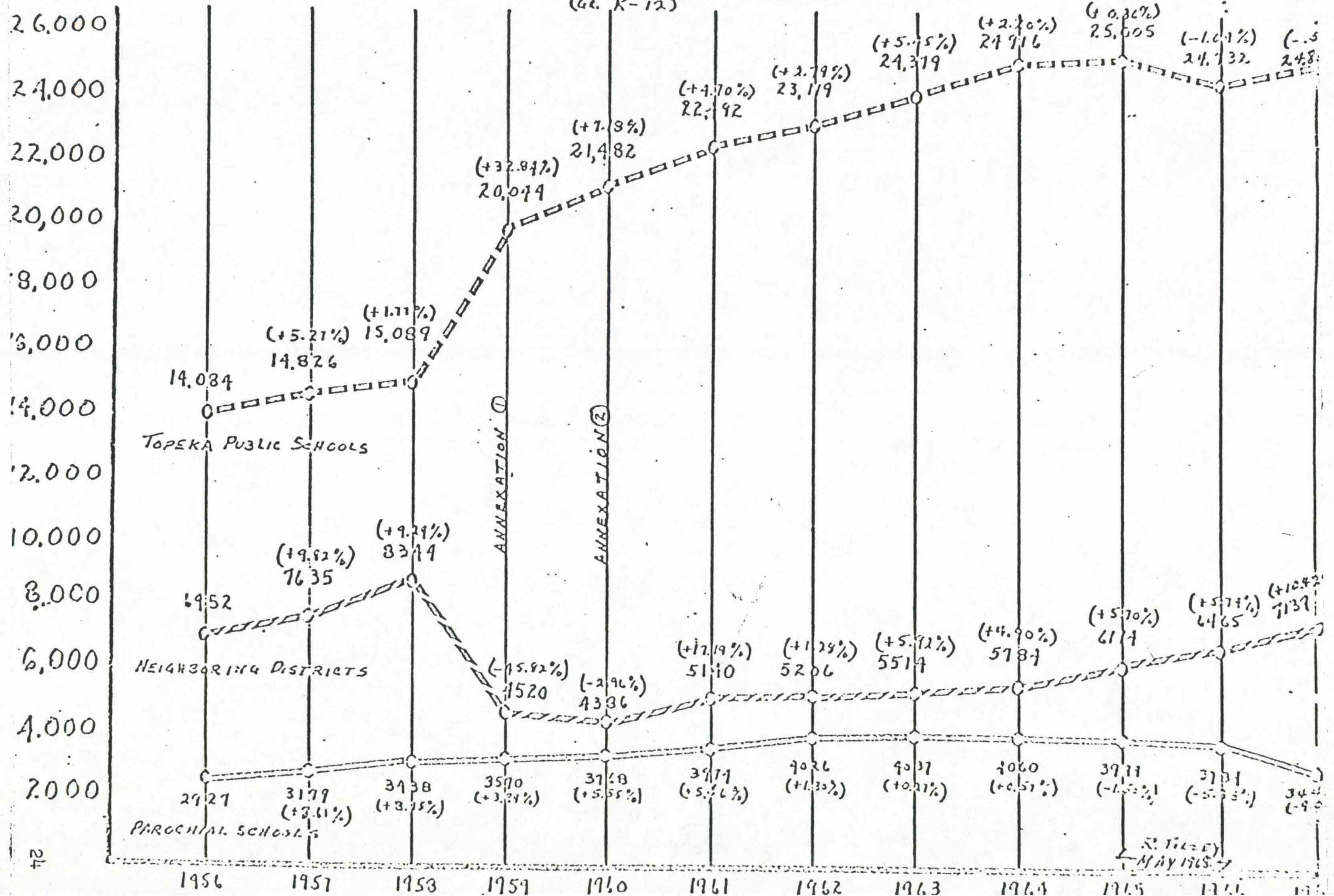

Elementary Enrollment Trends

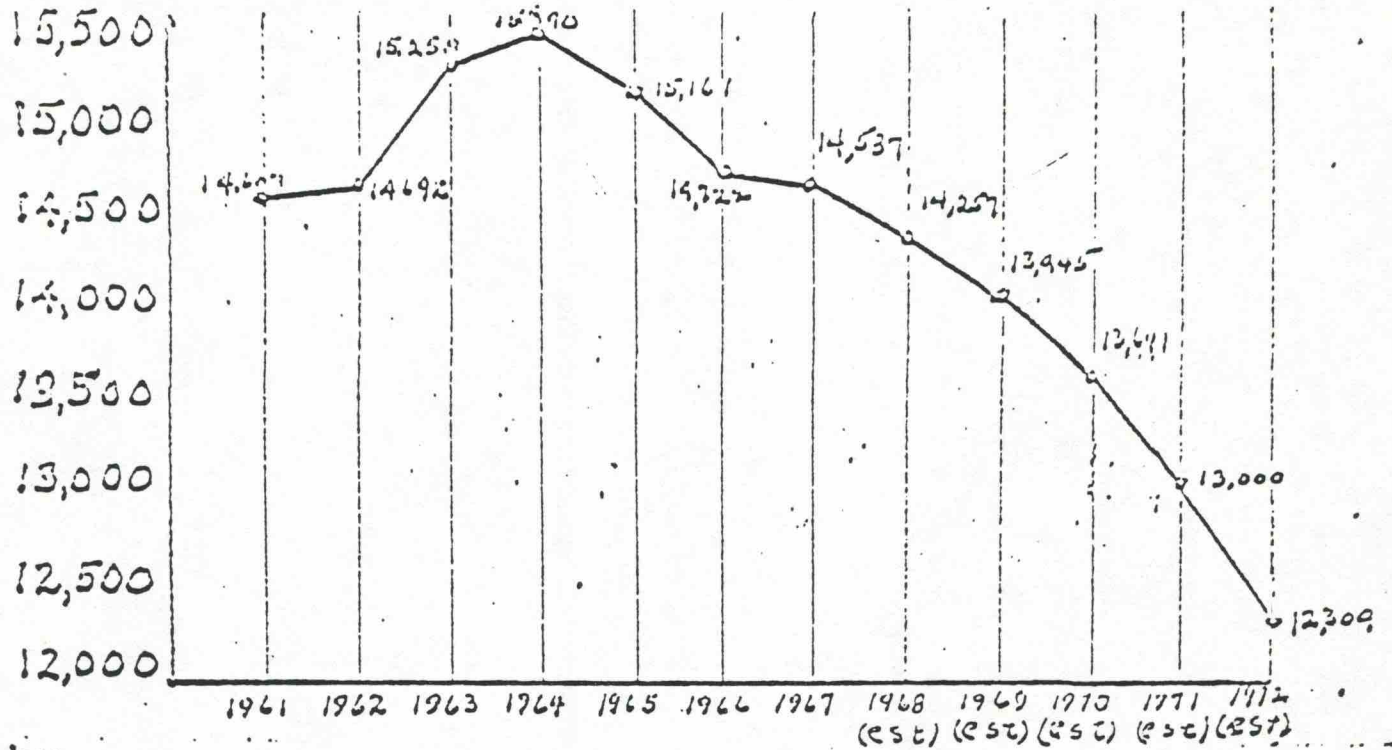

Secondary Enrollment Trends

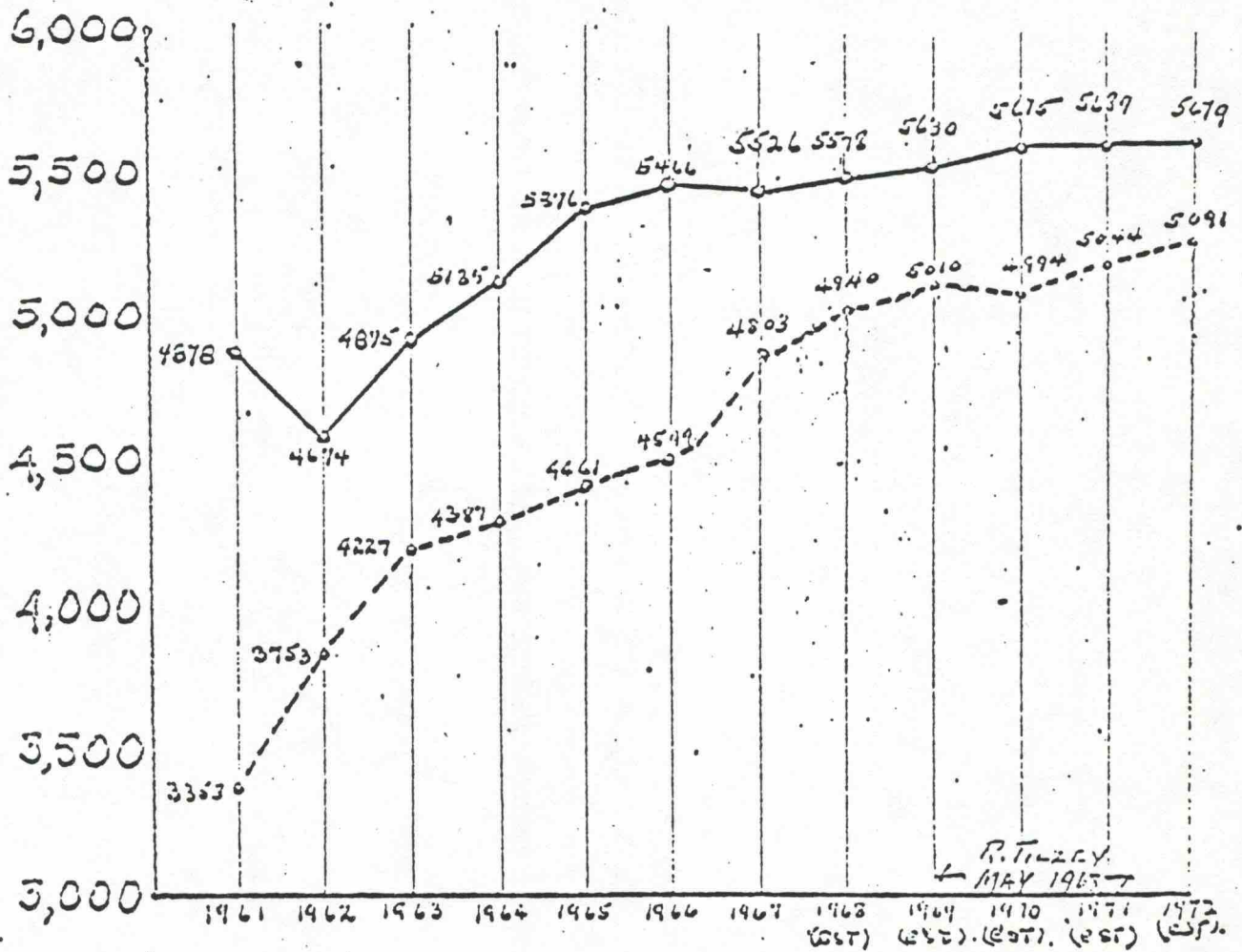

R. TILLEY
MAY 1967

KEY { ——— Grades 7-9
- - - - - Grades 10-12

City of Topeka Population Trend
1960-1967

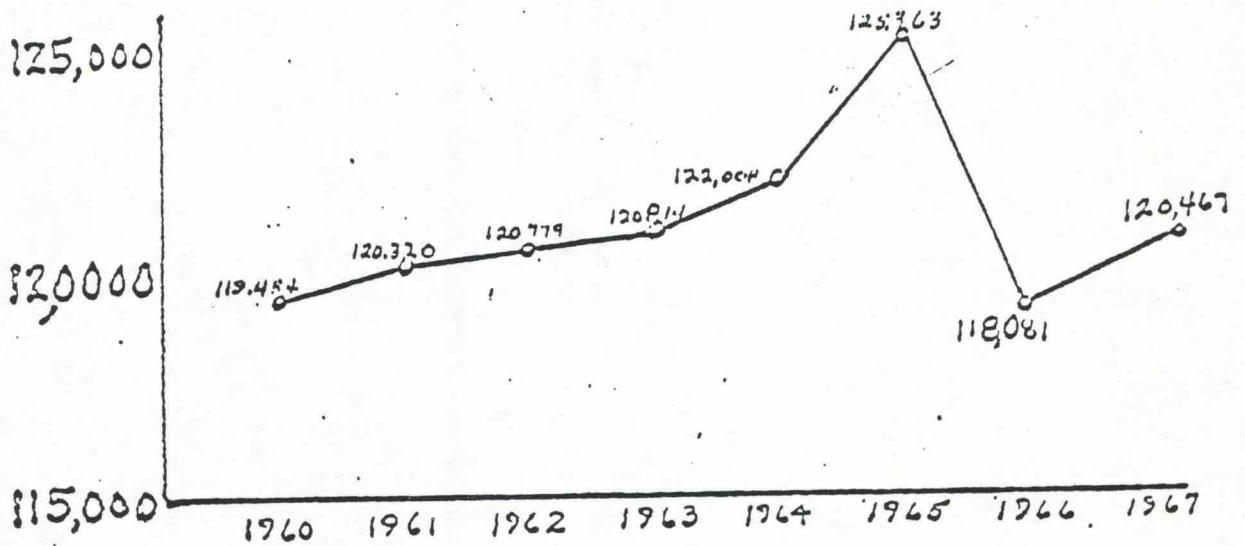

NOTE:

1960 (Federal Census)

1961-1967 State Dept. of Agriculture

Total Enrollment Trends
1961-1972

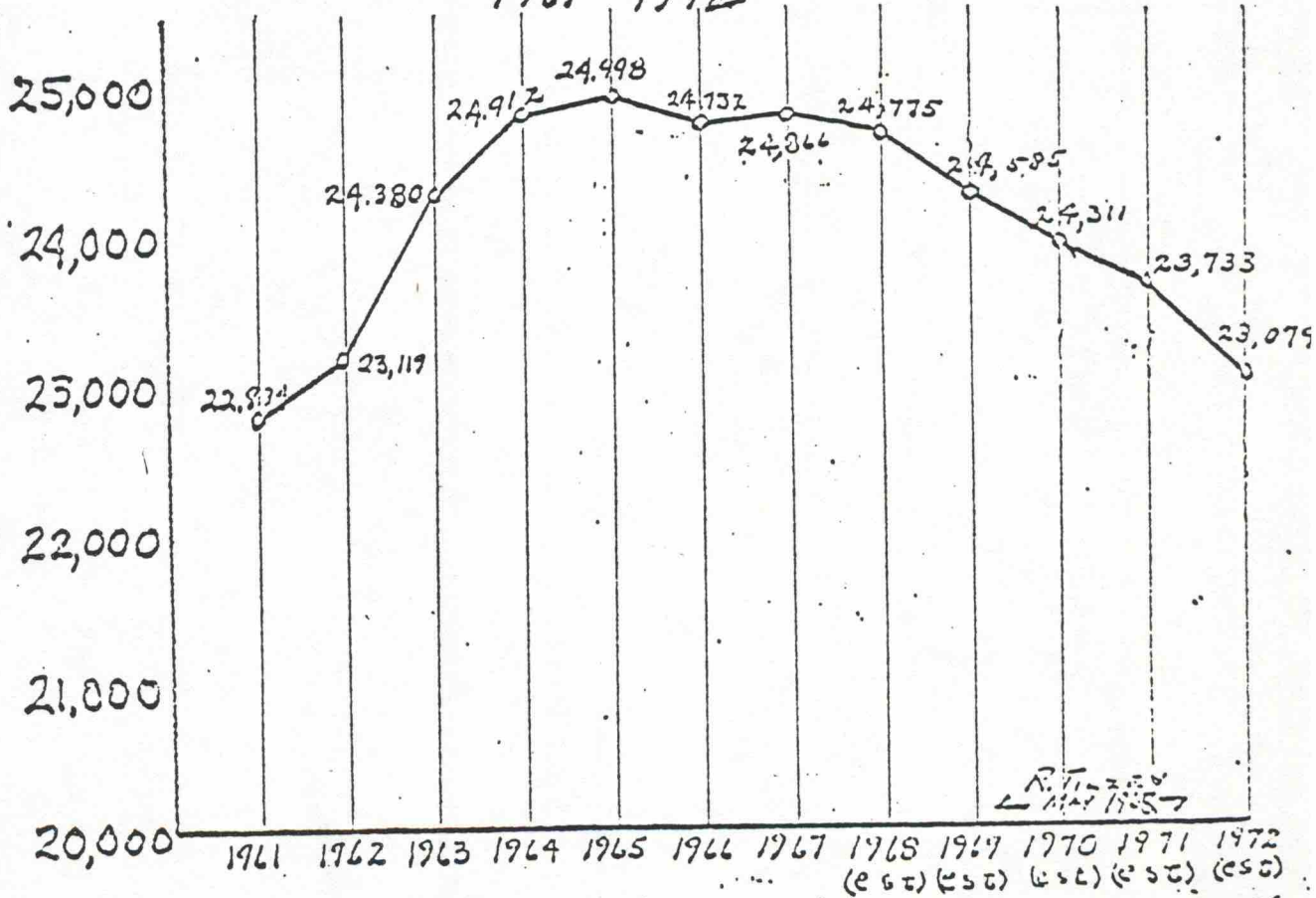

R. T. - 250
11-17-72

BIRTHS IN TOPEKA SCHOOL DISTRICT

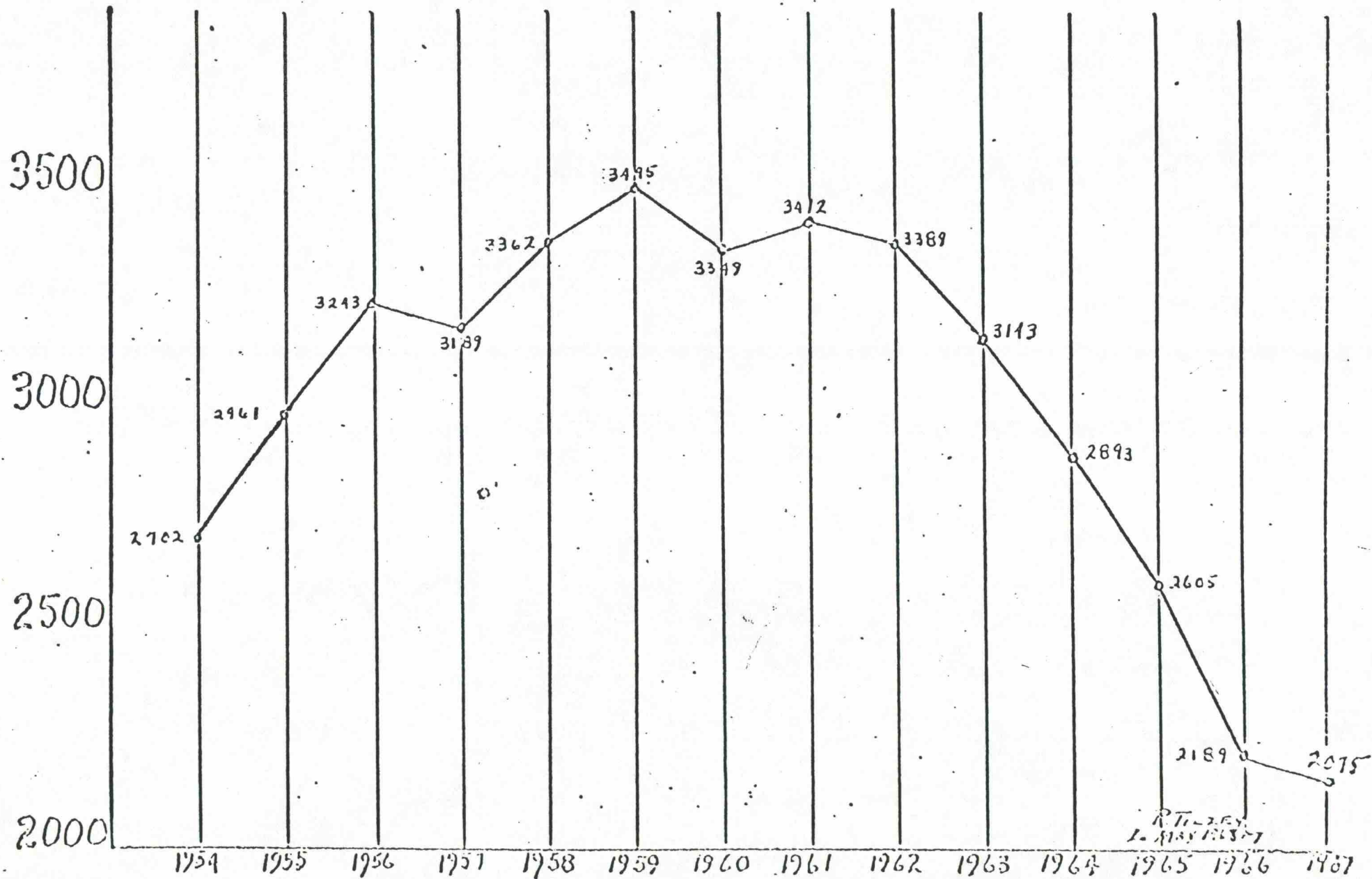

ESTIMATED ENROLLMENTS BY GRADE LEVELS
FOR SEPTEMBER 15 OF THE RESPECTIVE YEARS SHOWN
ELEMENTARY-5 YEARS JR. HIGH & SR. HIGH-10 YEARS

GRADE LEVEL	ACTUAL 9-15-67	68-69	69-70	70-71	71-72	72-73	73-74	74-75	75-76	76-77	77-78
KDGN	(2246)	2216	2138	2144	1847	1685					
FIRST	(2013)	1968	1941	1873	1878	1618					
SECOND	(2111)	1940	1906	1879	1814	1818					
THIRD	(2122)	2045	1879	1846	1820	1757	1761				
FOURTH	(1994)	2047	1973	1813	1781	1756	1695	1699			
FIFTH	(1941)	1952	2003	1931	1775	1743	1719	1659	1663		
SIXTH	(1942)	1894	1905	1955	1885	1732	1701	1678	1619	1623	
SEVENTH	(1840)	1924	1876	1887	1936	1867	1716	1685	1662	1601	1608
EIGHTH	(1782)	1800	1882	1835	1846	1894	1826	1678	1648	1626	1566
NINTH	(1831)	1779	1797	1879	1832	1843	1891	1823	1676	1646	1624
TENTH	(1736)	1752	1702	1720	1798	1753	1763	1809	1744	1604	1575
ELEVENTH	(1573)	1680	1695	1647	1664	1740	1696	1706	1750	1687	1552
TWELFTH	(1448)	1463	1563	1577	1532	1548	1620	1577	1587	1628	1569
TOTAL REG K-6		14062	13745	13441	12800	12109					
SP. ED. K-6		195	200	200	200	200					
TOTAL K-6		14257	13945	13641	13000	12309					
TOTAL REG 7-9		5503	5555	5601	5614	5604	5433	5186	4986	4873	4798
SP. ED. 7-9		75	75	75	75	75	75	75	75	75	75
TOTAL 7-9		5578	5630	5675	5689	5679	5508	5261	5061	4948	4873
TOTAL REG 10-12		4895	4960	4944	4994	5041	5079	5092	5081	4919	4696
SP. ED. 10-12		45	50	50	50	50	50	50	50	50	50
TOTAL 10-12		4940	5010	4994	5044	5091	5129	5142	5131	4969	4746
TOTAL REG K-12		24460	24260	23986	23408	22754					
SP. ED. K-12		315	325	325	325	325					
TOTAL K-12		24775	24585	24311	23733	23079					

ACTUAL NUMBER BELONGING
SEPTEMBER 15, 1967

TOTAL K-6	14,537
TOTAL 7-9	5,526
TOTAL 10-12	4,798
TOTAL K-12	24,861

BIRTHS IN TOPEKA SCHOOL DISTRICT		DECLINE FROM PREVIOUS YR.
YEAR	NUMBER	
1962	3389	23
1963	3143	246
1964	2893	250
1965	2605	288
1966	2189	416
1967	2075	114
TOTAL DECLINE 1961-1967		1337

February 15, 1968

BUILDING PROJECTS COMPLETED SINCE 1961

1962

1. Lafayette addition completed.

1963

1. Capper addition completed.
2. Hudson Elementary School completed.
3. Landon Junior High School completed.

1964

1. Curtis site expanded.
2. Curtis Junior High School addition completed.
3. Holliday Junior High School addition completed.
4. Linn Elementary School completed.
5. McClure addition completed.

1965

1. New elementary school vicinity of 31st and Arnold (Bishop).
2. Curtis site expanded.
3. Holliday Junior High library remodeled.
4. Topeka High auto mechanics area remodeled.
5. Topeka High home economics area remodeled.
6. Topeka West cafeteria expanded.
7. Topeka West science addition completed.

1966

1. Belvoir site expanded.
2. Replacement of the Highland Park Central building.
3. Highland Park High School science addition completed.
4. Highland Park Junior High heating plant replaced.
5. Highland Park Junior High library remodeled.
6. Monroe School, which housed Practical Nursing area, converted into regular classrooms.
7. Site acquired for new vocational school.
8. Highland Park Junior High site expanded.

1967

1. Replacement of portions of the Belvoir building.
2. New site for Central Park acquired.
3. New classroom addition at Rice completed.
4. Highland Park High School library carpeting, air conditioning, and expansion.

1968

1. State Street kitchen.
2. Topeka West High library and classroom.
3. Highland Park South Elementary 6-classroom, shelter, and multi-purpose room addition.
4. Landon Junior High kitchen storage addition.
5. Crane Junior High library and music room remodeling.
6. Potwin auditorium multi-purpose room remodeling.
7. Topeka High School Phase I.
8. Employ architect for Topeka High School study (Master Plan).
9. Kaw Area Vocational-Technical School completed.

AGES OF SCHOOL BUILDINGS NOW BEING UTILIZED
(May 1, 1968)

	YR. ORIG. STRUCTURE COMPLETED	AGE OF BLDG. IN 1968	YEAR OF ADDITION #1	YEAR OF ADDITION #2	YEAR OF ADDITION #3	YEAR OF ADDITION #4
Avondale East	1954	14 Yrs.	1956	1958		
Avondale S.W.	1957	11 Yrs.	1958			
Avondale West	1954	14 Yrs.	1955	1956		
Belvoir	1967	1 Yr.	(1956 and 1959 additions of 6 classrooms and kindergartens still in use.)			
Bishop	1965	3 Yrs.				
Central Park		0 Yrs.				
Clay	1926	42 Yrs.				
Crestview	1954	14 Yrs.				
Gage	1928	40 Yrs.				
Grant	1937	31 Yrs.				
H. P. Central	1966	2 Yrs.	(An 8-classroom wing built in 1953 still in use.)			
H. P. North	1955	13 Yrs.	1958			
H. P. South	1955	13 Yrs.	1958			
Hudson	1963	5 Yrs.				
Lafayette	1957	11 Yrs.	1962			
Linn	1964	4 Yrs.				
Lowman Hill	1959	9 Yrs.				
Lundgren	1950	18 Yrs.	1963			
McCarter	1957	11 Yrs.				
McClure	1962	6 Yrs.	1964			
McEachron	1959	9 Yrs.				
Monroe	1927	41 Yrs.				
Parkdale	1924	44 Yrs.	1962			
Polk	1962	6 Yrs.				
Potwin	1949	19 Yrs.				
Quincy	1962	6 Yrs.				
Quinton Heights	1954	14 Yrs.				
Randolph	1927	41 Yrs.				
Rice	1949	19 Yrs.	1955-58	1966		
Sheldon	1957	11 Yrs.				
State Street	1941	27 Yrs.				
Stout	1955	13 Yrs.				
Sumner	1935	33 Yrs.				
Whitson	1952	16 Yrs.				
Boswell	1923	45 Yrs.	1957			
Capper	1940	28 Yrs.	1955	1963		
Crane	1929	39 Yrs.				
Curtis	1927	41 Yrs.	1964			
East Topeka	1936	32 Yrs.				
Eisenhower	1961	7 Yrs.				
H. P. Junior High	1935	33 Yrs.	1959			
Holliday	1928	40 Yrs.	1964			
Jardine	1961	7 Yrs.				
Landon	1963	5 Yrs.				
Roosevelt	1926	42 Yrs.	1957			
H. P. Senior High	1950	18 Yrs.	1955	1965		
Topeka High	1931	37 Yrs.				
Topeka West High	1961	7 Yrs.	1963	1964	1965	1968
Dawson	1928	40 Yrs.	(Used as part of Kaw AVTS.)			

AGE OF ORIGINAL STRUCTURE
 GROUPED BY 5-YEAR PERIODS
 (May 1, 1968)

	<u>TOTAL</u>	<u>ELEMENTARY</u>	<u>JUNIOR HIGH</u>	<u>SENIOR HIGH</u>
1 to 5 Years	6	5	1	0
6 to 10 "	8	5	2	1
11 to 15 "	11	11	0	0
16 to 20 "	5	4	0	1
21 to 25 "	0	0	0	0
26 to 30 "	2	1	1	0
31 to 35 "	4	2	2	0
36 to 40 "	4	1	2	1
41 to 45 "	7	4	3	0
46 to 50 "	0	0	0	0
Over 50 "	0	0	0	0
TOTALS	*47	33	11	3

Average age of all buildings 20.04 years.

*Does not include Central Park because there is no building.

EKDAHL DAVIS AND DEPEW • ARCHITECTS

220 NEW ENGLAND BUILDING • TOPEKA, KANSAS 66603 • AREA CODE 913 CENTRAL 4-6664

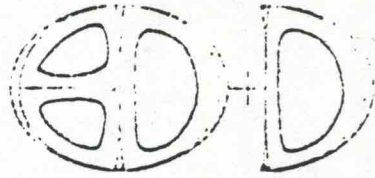

OSCAR S. EKDAHL, A.I.A. EVAN L. DAVIS, A.I.A. DON D. DEPEW, A.I.A.

HIGHLAND PARK HIGH SCHOOL - SCHEME I - COST PROJECTIONS APRIL, 1968
 ADDITIONS AND REMODELING FOR ENROLLMENT TO 1500 STUDENTS

Reference: Plan Scheme I dated 2-5-66
 Ek Dahl, Davis and Depew, Architects

Present enrollment 1080 students
 ADD 420 Students

A. New Physical Education Building, locker and dressing rooms, 2 class rooms, seating for 2500 in folding bleachers, 4 to 6 teaching stations, mechanical equipment room and attendant services. Gross area 34,050 s.f.			
	New construction	\$495,600.00	
	Site work	<u>12,400.00</u>	
			\$508,000.00
B. Add 2 science laboratories, preparation rooms and attendant services. Gain 1 class room in existing building (5000 s.f.)			
	New construction		82,000.00
C-1. Remodeling existing gym and locker-dressing rooms into cafeteria dining room, kitchen and class rooms, including some work on the second floor to add 6 classrooms and increase cafeteria services			
	Demolition and remodeling in boys' locker area for Cafeteria kitchen services	\$78,000.00	
	Remodeling in present gym (D.R. + 5 C.R.)	147,000.00	
	Remodel girls locker-dressing area (1 C.R.)	17,500.00	
	Remodel second floor for new corr.	<u>11,500.00</u>	
			254,000.00
C-2. Remodel existing cafeteria and kitchen for class rooms and attendant services.			
	Demolition and remodeling - Kitchen area	\$30,000.00	
	Remodeling in Dining Room area	<u>33,000.00</u>	
			63,000.00
D. Remodel bus garage from storage to arts and crafts room. Gain 1 class room in existing building.			
	Remodeling work		<u>26,500.00</u>
Total estimated for construction and remodeling			<u>\$933,500.00</u>

COST PROJECTIONS FOR FIXED EQUIPMENT:

(April 1968)

A.	Dressing-locker room equipment (salvage existing equipment)	\$ 8,000.00
	Folding bleachers (salvage 1200, add 1300)	16,700.00
B.	Science lab equipment	13,550.00
	Student lockers (30)	450.00
C-1.	Salvage and reinstall existing kitchen equipt.	5,000.00
	New stainless steel work in kitchen and food service	14,450.00
	Student lockers (170)	2,550.00
C-2.	Students lockers (220)	3,300.00
D.	Arts and Crafts - salvage and reinstall equipt.	<u>1,000.00</u>
	Total estimated cost of fixed equipment	\$65,000.00

SUMMARY:

New construction and remodeling	\$933,500.00
Fixed equipment	<u>65,000.00</u>
	998,500.00

PROFESSIONAL SERVICES:

A.	Construction	\$508,000.00		
	Fixed Equipment	<u>24,700.00</u>		
		\$532,700.00	@ 6.6%	\$35,160.00
B.	Construction	82,000.00		
	Fixed equipment	<u>14,000.00</u>		
		\$96,000.00	@ 7.6%	\$ 7,296.00
C-1.	Remodeling and Construction	\$254,000.00		
	Fixed equipment	<u>22,000.00</u>	@ 10%	27,600.00
C-2.	Remodeling and Construction	63,000.00		
	Fixed equipment	<u>3,300.00</u>		
		\$66,300.00	@ 10%	6,630.00
D.	Remodeling & Construction	\$27,500.00	@ 10%	<u>2,750.00</u>
	Total estimate professional services			\$79,436.00

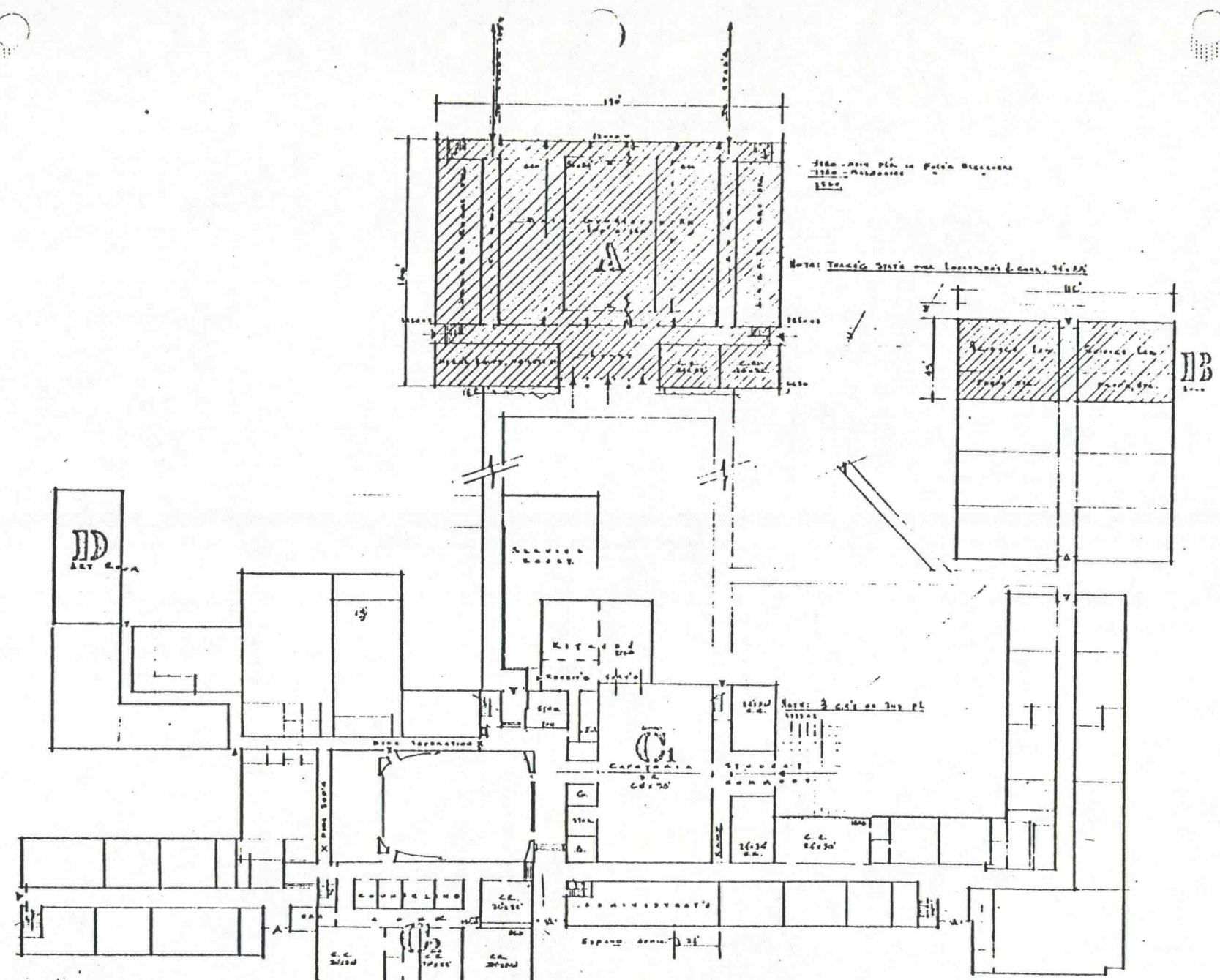

2160 - new pl. in Felt's Classroom
 2160 - Remodeling
 1500

NOTE: TRACING STATE AND LOS ANGELES & CO., 1400 E.

NOTE: 2' 6" on this pl.

- A \$ 500,000 PRV. BIOC. BUILDG.
 - B \$ 2,000 ADD. 2 SCIENCE LABS ETC.
 - C1 \$ 250,000 REMODEL GYM & LACROSS AND
 ENLARGED CAPT. MICHIESE GYM.
 2 CLASS ROOMS
 - C2 \$ 63,000 REMODEL CAPT. R. 8 BLDG. TO
 PROVIDE 4 C.E.'S OFFICES.
 - D \$ 26,000 REMODEL ART CLASS TO 200 SEAT.
- TOTAL \$ 933,500 REMODEL & NEW CONSTR.
 \$ 65,000 FIXED EQUIP.

REMODELING AND ADDITIONS
HIGHLAND PARK HIGH SCHOOL

NEW CONSTRUCTION
 REMODELING

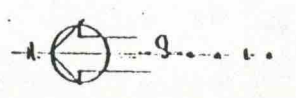

1" = 32' 0"

SCHLAE II

SEARS BROS. & CO. ARCHT. & ENGRS.
 2 - 5 - 11

EKDAHL DAVIS AND DEPEW • ARCHITECTS

220 NEW ENGLAND BUILDING • TOPEKA, KANSAS 66603 • AREA CODE 913 CENTRAL 4-6664

OSCAR S. EKDAHL, A.I.A. EVAN L. DAVIS, A.I.A. DON D. DEPEW, A.I.A.

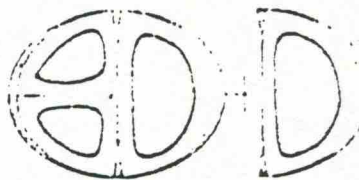

TOPEKA WEST HIGH SCHOOL - COST PROJECTIONS APRIL, 1968

ADDITIONS AND REMODELING FOR ENROLLMENT TO 1800 STUDENTS

Reference: Plan Scheme dated 2-7-66
Ekdahl, Davis and Depew, Architects

Present enrollment 1200 students
ADD 600 students

A-1.	4 large (1200 s.f.) and 4 normal sized class rooms and attendant services. (12,094 s.f.)		
	Modifications to existing building for attachment of new construction	\$ 8,500.00	
	New construction	<u>193,500.00</u>	\$202,000.00
A-2.	Physical Education gym, increase P.E. dressing rooms, equipment storage, balcony for P.E. teaching and for additional spectator seating 400 in folding bleachers (14,080 s.f.)		
	Modifications to existing building for attachment of new construction	\$ 15,000.00	
	New construction	<u>259,500.00</u>	274,500.00
B.	Library - Construction in Progress (\$97,880.)		
C.	Increase administrative office space and add 2 class rooms (800 s.f. + 2400 s.f.)		
	Remodeling in existing building and modifications for attachment of new construction	\$ 5,000.00	
	New Construction - administrative	13,600.00	
	New Construction - class rooms	<u>43,200.00</u>	61,800.00
D.	Mechanical Drawing Room, auditorium (seating 1200) stage, dressing rooms and attendant services (17,494 s.f.)		
	Modifications to existing building for attachment of new construction	\$ 7,000.00	
	Site work	12,000.00	
	New construction	<u>297,400.00</u>	316,400.00
E.	Add 2 science laboratories, preparation rooms and attendant services. (4665 s.f.)		<u>87,780.00</u>
	Total estimated construction cost		\$942,500.00

COST PROJECTIONS FOR FIXED EQUIPMENT: (April 1968)

A-1. Student lockers (400)	\$ 6,000.00	
A-2. Dressing and Locker Room equipment	10,000.00	
Folding bleachers (400)	4,400.00	
B. Library	0.00	
C. Student Lockers (50)	750.00	
D. Auditorium seating (1200)	26,400.00	
Stage Lighting and equipment	25,000.00	
E. Science lab equipment	14,000.00	
Student lockers (150)	<u>2,250.00</u>	
		\$88,800.00

SUMMARY:

New Construction and modifications	\$942,500.00
Fixed equipment	<u>88,800.00</u>
Total estimated costs	1,031,300.00

Alternate A-1 -- Separate Building to match present little schools in lieu of building addition A-1.

New construction	13,780 s.f. @ \$16	\$221,800.00	- 13,780 s.f.
Site work		<u>5,000.00</u>	
		226,800.00	
Estimated cost of A-1 Addn.		<u>202,000.00</u>	- 12,094 s.f.
Add'l cost as separate bldg.		24,800.00	<u>1,686 s.f.</u>

PROFESSIONAL SERVICES:

A-1. Construction	\$202,000.00	
Fixed Equipment	<u>6,000.00</u>	
	\$208,000.00 @ 7.2%	\$14,760.00
A-2. Construction	\$274,500.00	
Fixed Equipment	<u>14,400.00</u>	
	\$288,900.00 @ 7%	\$20,225.00
B. In progress	(\$ 97,880.00)	
C. Construction & Remodeling	\$61,800.00	
Fixed Equipment	<u>750.00</u>	
	\$62,550.00 @ 10%	\$ 6,250.00
D. Construction	\$316,400.00	
Fixed equipment	<u>51,400.00</u>	
	\$367,800.00 @ 6.9%	25,380.00
E. Construction	87,800.00	
Fixed Equipment	<u>16,250.00</u>	
	\$104,050.00 @ 7.6%	<u>7,905.00</u>
Total estimated professional services		\$74,520.00

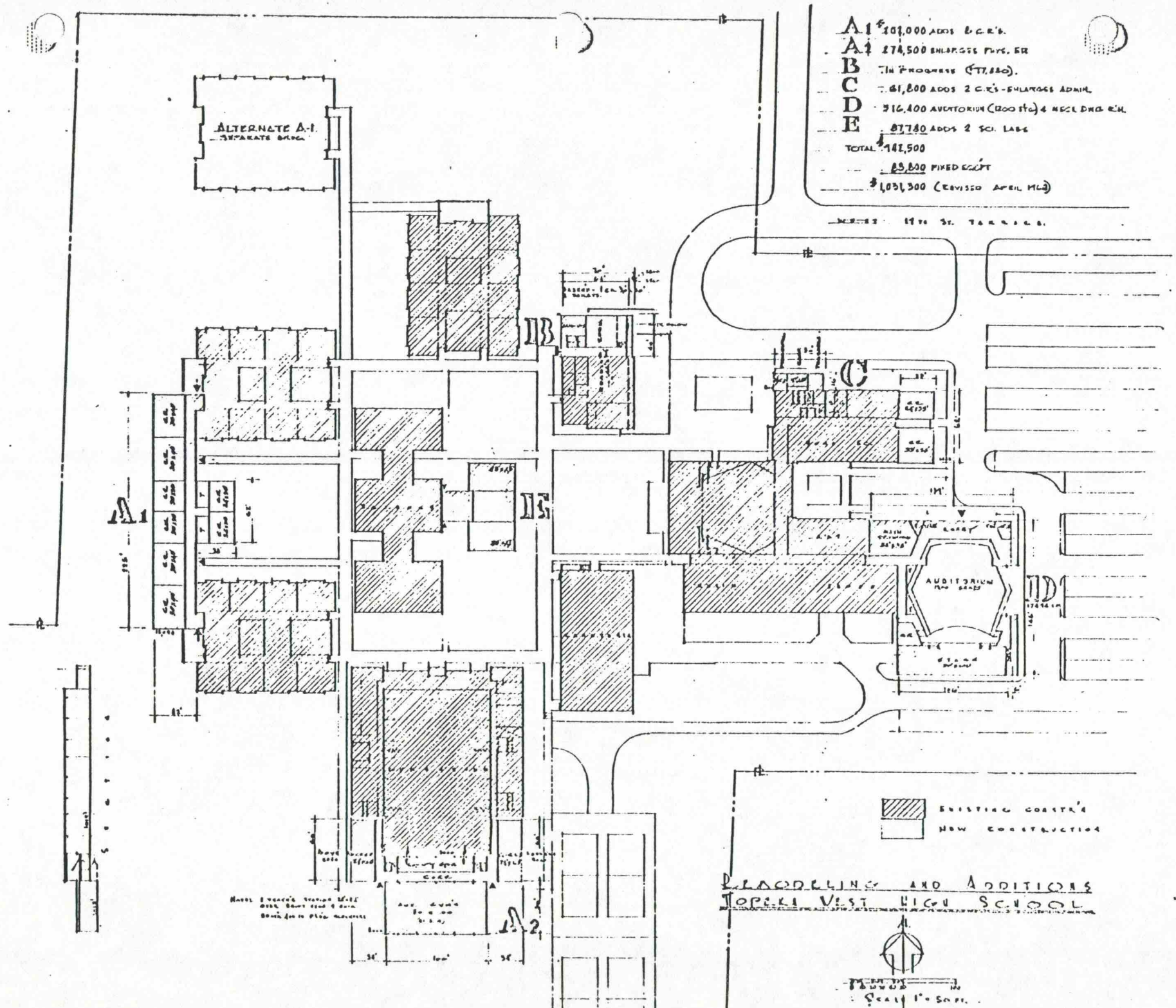

- A1 \$101,000 ADDS 6 C.R.'s
- A2 274,500 ENLARGES PHYS. ER
- B IN PROGRESS (\$77,840)
- C 61,800 ADDS 2 C.R.'S - ENLARGES ADMIN
- D 316,400 AUDITORIUM (2000 SEAT) & NECE DRG RM
- E 87,740 ADDS 2 SCI LABS
- TOTAL 1,412,500
- 29,800 FIXED COST
- \$1,051,300 (REVISED APRIL 1963)

NEE: 17th St. TERRACE

 EXISTING CONSTR.
 NEW CONSTRUCTION

REMODELING AND ADDITIONS
TOPELI VISTI HIGH SCHOOL



Scale 1" = 50 FT.

ALTERNATE A-1
SEPARATE BLDG.

AUDITORIUM
2000 SEAT

Note: Elevator, Stairs, etc.
 Note: Elevator, Stairs, etc.
 Note: Elevator, Stairs, etc.

AREAS OF TRACTS OF LAND OWNED BY THE TOPEKA BOARD OF EDUCATION
(Areas Given Include the Portions of Land Covered by Structures)
May 1, 1968

ELEMENTARY

School or Site Name	Location	Approx. Area in Sq. Feet	Approx. Area (Acres)	Rank in Order of Size	State Rec. Size* (Acres)
Avondale East	455 Golf Park	297,500	6.830	8	16.6
Avondale S. W.	1600 W. 34th	326,156	7.488	7	14.5
Avondale West	3201 Westview	332,831	7.641	6	15.4
Belvoir	11th & Bellview	236,475	5.428	16	14.0
Bishop	3611 W. 31st	344,396	7.906	4	13.3
Central Park	14th & Buchanan	295,861	6.792	9	14.8
Clay	635 Clay	75,100	1.724	34	12.4
Crestview	2200 Eveningside	349,879	8.032	3	15.7
Gage	3028 W. Eighth	219,236	5.033	17	13.9
Grant	1231 Eugene	115,740	2.657	28	14.5
H. P. Central	2714 Indiana	189,630	4.353	21	17.2
H. P. North	20th & Indiana	196,122	4.502	20	14.5
H. P. South	34th & Indiana	285,625	6.557	12	14.5
Hudson	2400 Highland	400,750	9.200	1	12.7
Lafayette	420 California	255,131	5.857	15	16.6
Linn	200 East 40th	276,052	6.337	13	14.5
Lowman Hill	1101 Garfield	100,750	2.313	30	14.2
Lundgren	1020 Forest	144,720	3.322	25	14.5
McCarter	5512 West 16th	294,030	6.750	10	15.1
McClure	2529 Chelsea	334,288	7.674	5	14.5
McEachron	4433 West 29th	356,443	8.183	2	14.5
Monroe	15th & Monroe	87,843	2.017	32	13.3
Parkdale	10th & Chandler	175,000	4.017	23	15.4
Polk	Huntoon & Polk	56,250	1.290	35	12.1
Potwin	208 Elmwood	96,094	2.205	31	13.3
Quincy	1500 N. Quincy	129,427	2.971	27	13.9
Quinton Heights	2331 Topeka Blvd.	209,700	4.814	18	12.7
Randolph	1400 Randolph	177,350	4.071	22	14.8
Rice	550 Norwood	206,049	4.730	19	12.7
Sheldon	1155 Seabrook	105,825	2.429	29	13.0
State Street	Division & Sumner	170,400	3.912	24	14.5
Stout	2303 College	287,750	6.606	11	14.2
Sumner	4th & Western	87,655	2.012	33	13.0
Whitson	1725 Arnold	258,977	5.945	14	15.4
TOTAL ELEMENTARY		7,475,035	171.598		486.2
AVERAGE SIZE		219,854	5.047		14.3

*Based on School Effective Instructional Capacity

AREAS OF TRACTS OF LAND OWNED BY THE TOPEKA BOARD OF EDUCATION
(Areas Given Include the Portions of Land Covered by Structures)
May 1, 1968

JUNIOR HIGH

School or Site Name	Location	Approx. Area in Sq. Feet	Approx. Area (Acres)	Rank in Order of Size	State Rec. Size* (Acres)
Boswell**	13th & Boswell	146,250	3.357	6	26.5
Capper	1900 Hope	350,370	8.043	4	26.0
Crane**	1620 Tyler	110,550	2.538	10	24.5
Curtis**	316 W. Grant	140,400	3.223	7	24.5
East Topeka**	1210 East 8th	137,500	3.157	8	28.0
Eisenhower	33d & Minnesota	800,781	18.383	2	27.5
Highland Park	2640 Indiana	107,300	2.463	11	25.2
Holliday**	2301 E. Laurent	131,340	3.015	9	25.5
Jardine	33d & Wayne	1,167,800	26.810	1	27.5
Landon	731 Fairlawn	624,737	14.342	3	23.8
Roosevelt	3d & Buchanan	168,525	3.868	5	25.0
TOTAL JUNIOR HIGH		3,885,553	89.199		284.0
AVERAGE SIZE		353,232	8.109		25.8

*Based on School Effective Instructional Capacity
**This school uses an auxiliary site. See the Auxiliary Site List.

AREAS OF TRACTS OF LAND OWNED BY THE TOPEKA BOARD OF EDUCATION
 (Areas Given Include the Portions of Land Covered by Structures)
 May 1, 1968

SENIOR HIGH

School or Site Name	Location	Approx. Area in Sq. Feet	Approx. Area (Acres)	Rank in Order of Size	State Rec. Size* (Acres)
Highland Park	25th & California	1,526,850	35.052	2	43.0
Topeka High**	800 West 10th	534,920	12.280	3	54.8
Topeka West	2001 Fairlawn	1,681,680	38.606	1	43.0
TOTAL SENIOR HIGH		3,743,450	85.938		140.8
AVERAGE SIZE		1,247,816	28.646		46.7

*Based on School Effective Instructional Capacity
 **This school uses an auxiliary site. See the Auxiliary Site List.

AREAS OF TRACTS OF LAND OWNED BY THE TOPEKA BOARD OF EDUCATION
(Areas Given Include the Portions of Land Covered by Structures)
May 1, 1968

MISCELLANEOUS SITES

School or Site Name	Location	Approx. Area in Sq. Feet	Approx. Area (Acres)
<u>MISCELLANEOUS SITES WITH EXISTING STRUCTURES</u>			
Administration Bldg.	415 West 8th	6,500	.150
Maintenance Shop	13th & Quincy	39,500	.906
McKinley - Storage	Gordon & N. Western	58,575	1.344
Area Voc. Tech. Sch.	Huntoon & Chatham	2,035,597	46.731
Buchanan - Storeroom	12th & Buchanan	53,500	1.230
Van Buren - IRC	16th & Van Buren	40,500	.930
Dawson - Pract. Nurs.	3600 Seward Ave.	69,360	1.592
TOTAL MISCELLANEOUS SITES		2,303,532	52.883
<u>AUXILIARY SITES USED BY SOME SCHOOLS</u>			
Chandler Field	11th & Chandler	363,726	8.350 (East Topeka, THS)
Curtis Jr. Ath. Fd.	Paramount & Central	130,680	3.000 (Curtis)
Holliday Ath. Fd.	Division & Chester	301,200	6.915 (Holliday)
So. Topeka Ath. Fd.	23d & Tyler	760,122	17.450 (Boswell, Crane)
TOTAL AUXILIARY SITES		1,555,728	35.715 (Not included in school averages)
<u>SITES CURRENTLY WITHOUT STRUCTURES</u>			
Hudson School Area			
Location	23d & Highland	400,750	9.200
Menninger Elem. Site	8th & Morningside	449,460	10.318
Marjorie French			
Jr. High Site	33d & Fairlawn	844,200	19.380
Elementary Site	33d & Chelsea	348,400	7.998
Elementary Site	37th & Atwood	272,600	6.258
TOTAL SITES WITHOUT STRUCTURES		2,315,410	53.154

AREAS OF TRACTS OF LAND OWNED BY THE TOPEKA BOARD OF EDUCATION
(Areas Given Include the Portions of Land Covered by Structures)
May 1, 1968

TOTALS

<u>Group of Sites</u>	<u>Approx. Area in Sq. Feet</u>	<u>Approx. Area (Acres)</u>
Elementary	7,475,035	171.598
Junior High	3,885,553	89.199
Senior High	3,743,450	85.938
Miscellaneous	6,174,670	141.751
GRAND TOTAL	21,278,708	488.486